

Courses down the Creek

- N 41 W 66 P
- N 74 W 30
- N 52 W 48
- N 23 W 20
- N 5 E 114
- N 17 E 40
- N 52 E 20
- N 65 E 38
- S 52 E 58
- N 53 E 50

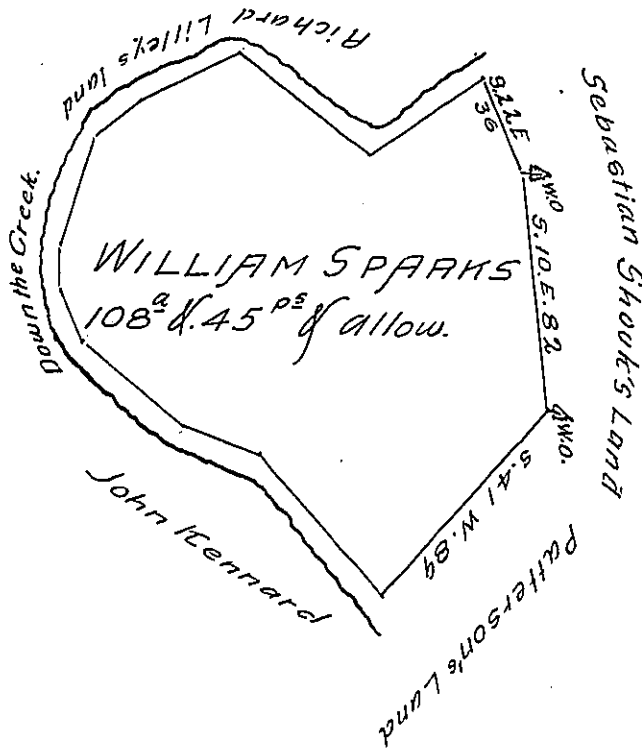

A Draught of a Tract of Land situate on the South side of the
 Raystown Branch of Juniata—then in Cumberland now Bedford
 County containing One hundred and eight acres and forty
 five perches with the usual allowance of six per Cent for Roads
 &c^s Surveyed for William Sparks the 3^d day of August 1786
 In pursuance of an order of Survey dated February 6th 1767
 No 2705

George Woods D.S.

To John Lukens Esq^t S.G.

IN TESTIMONY that the above is a copy of the original remaining on file in
 the Department of Internal Affairs of Pennsylvania, made
 conformably to an Act of Assembly approved the 16th day of
 February 1833, I have hereunto set my hand and caused
 the Seal of said Department to be affixed at Harrisburg,
 this nineteenth day of December 1906

James P. Brown
 Secretary of Internal Affairs.